



**MILES ESTATE AGENTS**

**10 Four Acre Mead Bishops Lydeard  
Taunton TA4 3NW £330,000**





A good size 3 bed detached bungalow set in good size gardens and close to the amenities of this ever popular Quantock village 6 miles North West of Taunton. Spacious lounge/dining room, kitchen with potential to re-fit, garage and parking. Immediately available with NO ONWARD CHAIN. Freehold Council Tax Band D EPC : C







## Features:

- Entrance porch
- Entrance hall
- Spacious lounge/dining room
- Good size kitchen
- 3 bedrooms
- Shower room
- Separate cloakroom
- Enclosed garden with summerhouse
- Single garage & ample parking
- NO ONWARD CHAIN
- Freehold
- Council Tax Band D
- EPC : C





## Four Acre Mead, Bishops Lydeard, Taunton, TA4

Approximate Area = 923 sq ft / 85.7 sq m

Garage = 141 sq ft / 13 sq m

Outbuilding = 72 sq ft / 6.6 sq m

Total = 1136 sq ft / 105.3 sq m

For identification only - Not to scale

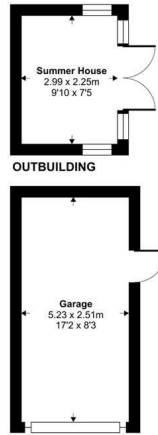
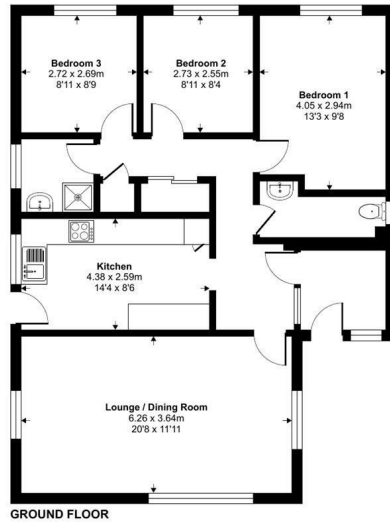

Energy Efficiency Rating		
	Current	Potential
Very energy efficient - lower running costs		
(92-100) <b>A</b>		
(81-91) <b>B</b>		
(69-80) <b>C</b>		
(55-68) <b>D</b>		
(39-54) <b>E</b>		
(21-38) <b>F</b>		
(1-20) <b>G</b>		
Not energy efficient - higher running costs		
<b>England &amp; Wales</b>	EU Directive 2002/91/EC	



Viewings strictly through the selling agents:

**Miles Estate Agents**

2 Piffin Lane, Bishops Lydeard, Taunton,  
Somerset, TA4 3AS

**Tel: 01823 470 500**

[lydeard@milesestateagents.co.uk](mailto:lydeard@milesestateagents.co.uk)

[www.milesestateagents.co.uk](http://www.milesestateagents.co.uk)

**rightmove**

**OnTheMarket.com**

**MILES ESTATE AGENTS**

